

✓

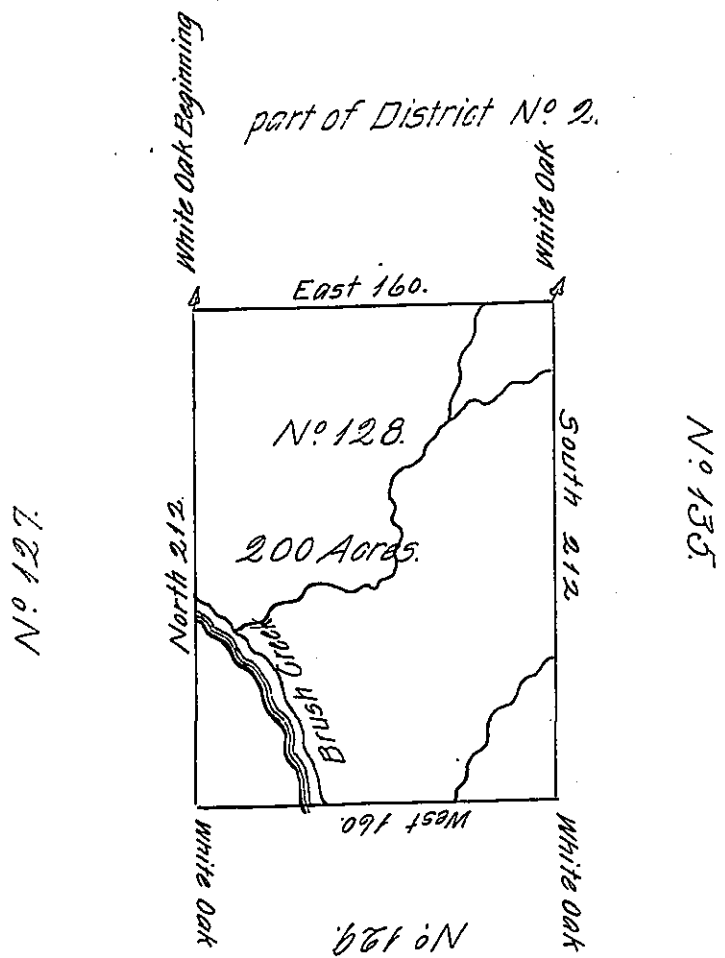

The above is a Draught of a Survey Made in the Month of July 1785. in Pursuance of Instructions from the Surveyor General Dated January 22^d 1785. Situate on the North side of the Ohio—on the Waters of Brush Creek in District Nº 2. Containing two hundred Acres with Allowance of 6 P Cent.

Dan! Leet D.S.

John Lukens Esq. Surv. Gen.

IN TESTIMONY that the above is a copy of the original remaining on file in the Department of Internal Affairs of Pennsylvania, made conformably to an Act of Assembly approved the 16th day of February, 1833, I have hereunto set my Hand and caused the Seal of said Department to be affixed at Harrisburg, this fourteenth day of November 1905.

Lea C. R. Brown
Secretary of Internal Affairs.